

SINGLE RISER FOR BOILER MODELS:

3-6 SECTION, GAS-STEAM BOILERS
KIT PN 850095U

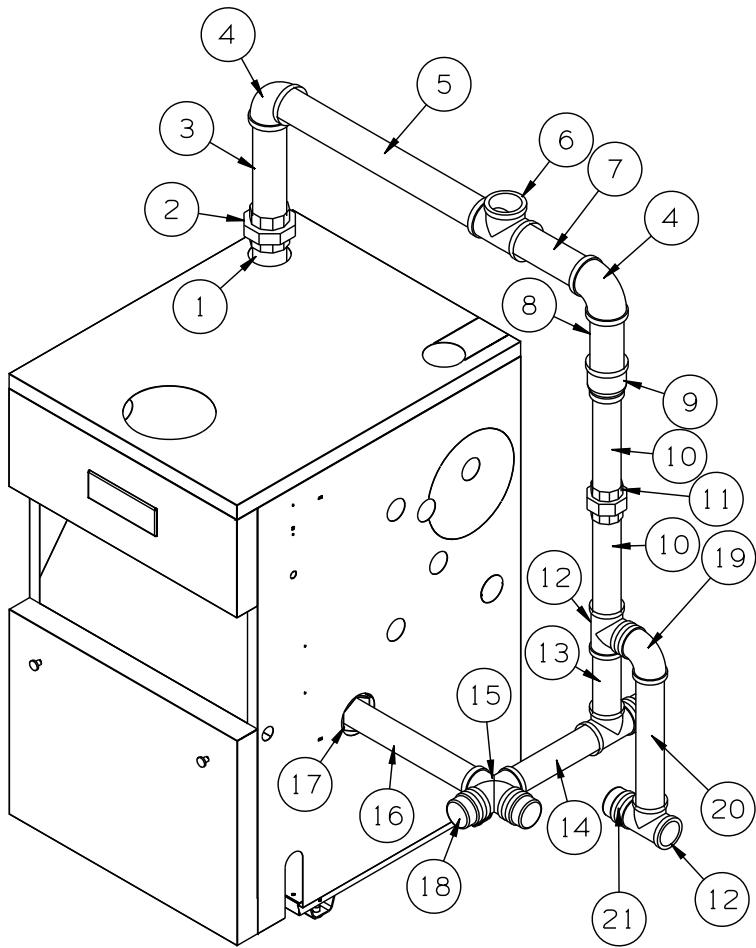

Number	Quantity In Kit	Description
1	0 (Note 1)	2" x 8" Pipe Nipple
2	1	2" Union
3	1	2" x 9" Pipe Nipple
4	2	2" - 90° Elbow
5 (3 Sec.)	1	2" x 10-1/2" Pipe Nipple
5 (4 Sec.)	1	2" x 14" Pipe Nipple
5 (5 Sec.)	1	2" x 17" Pipe Nipple
5 (6 Sec.)	1	2" x 20-1/2" Pipe Nipple
6	1	2" - Tee
7	1	2" x 7" Pipe Nipple
8	1	2" x 5-1/2" Pipe Nipple
9	1	2" x 1-1/2" Reducer
10	2	1-1/2" x 9" Pipe Nipple
11	1	1-1/2" - Union
12	3	1-1/2" - Tee
13	1	1-1/2" x 6" Pipe Nipple (Note 2)
14	1	1-1/2" x 8-1/2" Pipe Nipple (Note 2)
15	1	1-1/2" - Cross
16	1	1-1/2" x 13" Pipe Nipple (Note 2)
17	1	2" x 1-1/2" - Hex Bushing
18	4	1-1/2" - Cap
19	1	1-1/2" - 90° Elbow
20	1	1-1/2" x 12" Pipe Nipple
21	5	1-1/2" x Close Nipple

NOTES: 1. 2" X 8" NIPPLE SHOWN SHIPS WITH BOILER.
2. DUE TO VARIATION IN MAKE UP DIMENSIONS,
LENGTH OF THESE NIPPLES MAY NEED TO BE
ADJUSTED.
3. CONSULT INSTALLATION MANUAL FOR
ADDITIONAL INFORMATION ON PIPING.